

# A4K SKYHAWK

1:32 SCALE MODEL KIT



## ASSEMBLY INSTRUCTIONS

### BEFORE YOU BEGIN

- Print out the 7 model kit sheets and the 4 instruction sheets on any standard laser or ink-jet printer (a colour printer is recommended) on A4 size paper. Paper grades from 80gsm to 170gsm are suitable, but check the manufacturer's specifications for your printer's capabilities.
- Paper grain is very important! The grain must run long through the A4 sheet—this is true of most commercial grades. You can check this by tearing a sheet in both directions. The grain direction will be indicated by the smoothest tear.
- To assemble the A4K Skyhawk, you will need the following tools: A sharp hobby knife (or scalpel), a cutting mat (or a piece of thick cardboard) and a ruler. The model does not require glue.
- Cut out along the solid white lines and fold on the dashed lines.

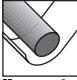
- To make a crisp fold, use the dull side of your knife to *lightly* score along the dashed lines.
- All folds are Peak folds\* unless otherwise noted as Valley folds\*\*.
- Before removing the pieces from the sheets, study each one and it's description carefully.
- When you see this symbol  you will be required to curl the paper. To do this you will need a *round* pencil or similar object. (see diagram below right).
- Build the model in the correct sequence as presented in these instructions.

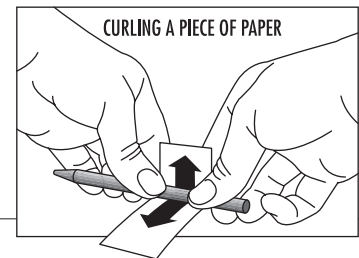

1

### FUSELAGE MAINFRAME (TOP AND BOTTOM)

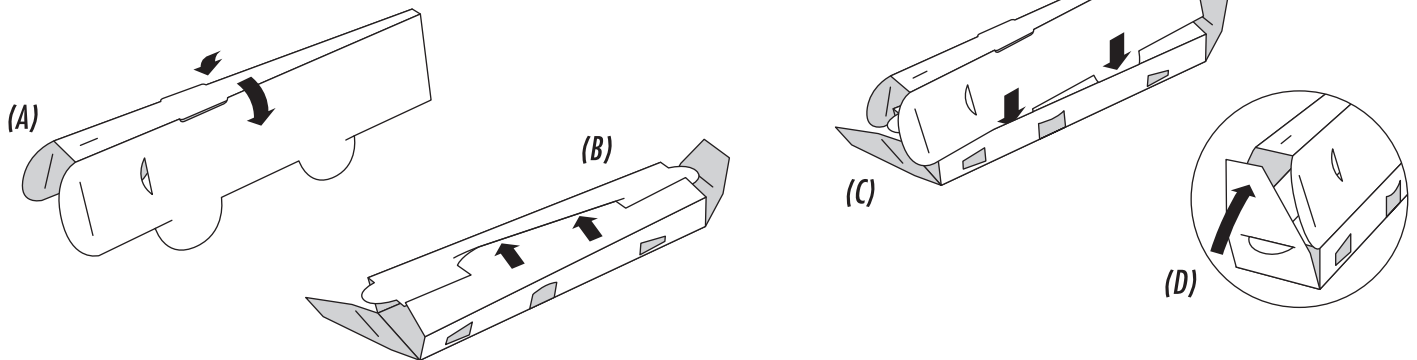

2

### FUSELAGE

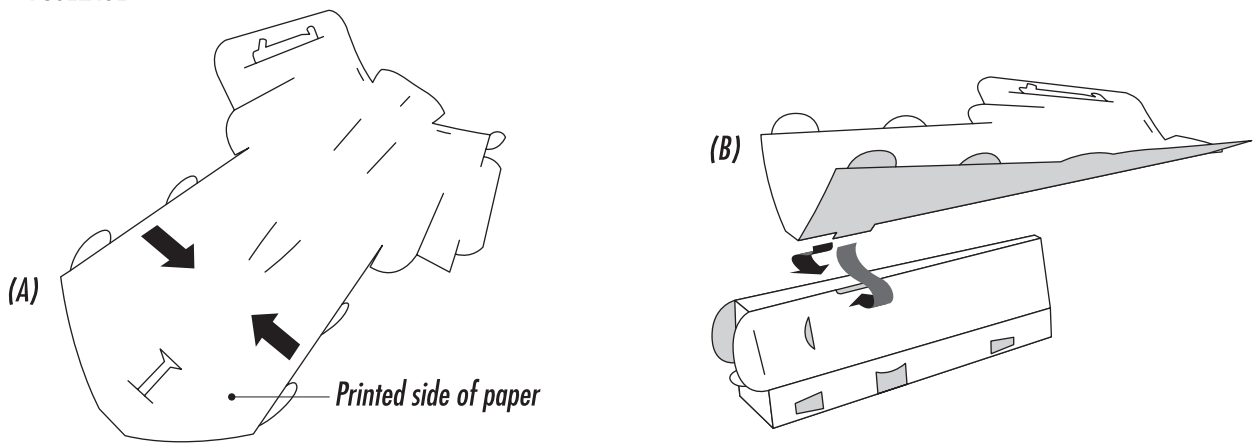

3

FUSELAGE (CONT.)

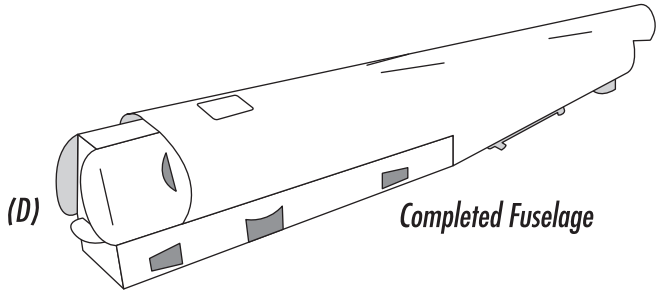
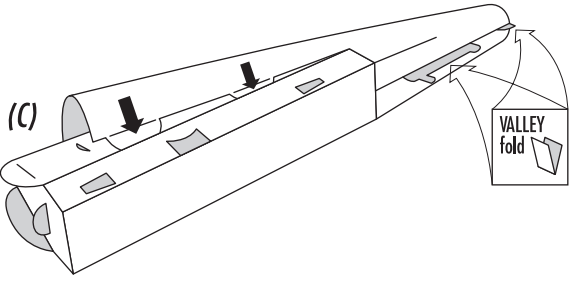
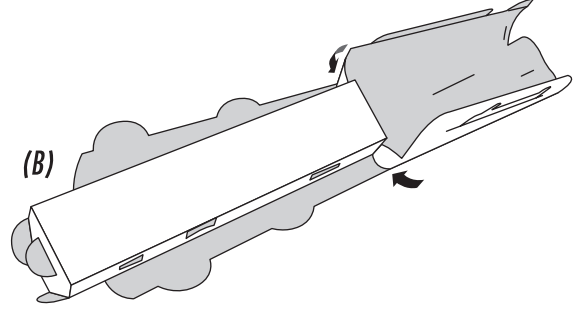
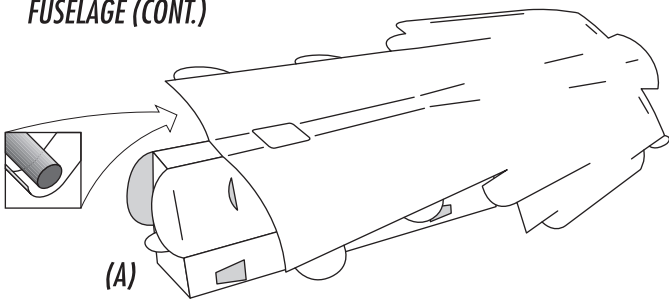

4

WINGS (x2)

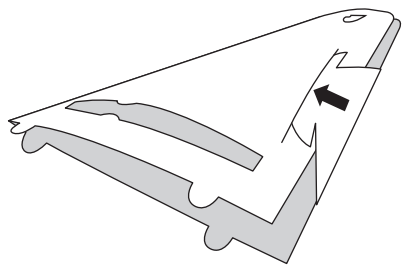

5

WING SPAR

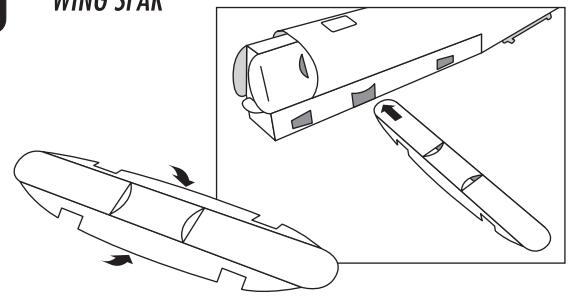

6

WINGS (x2) / FUSELAGE

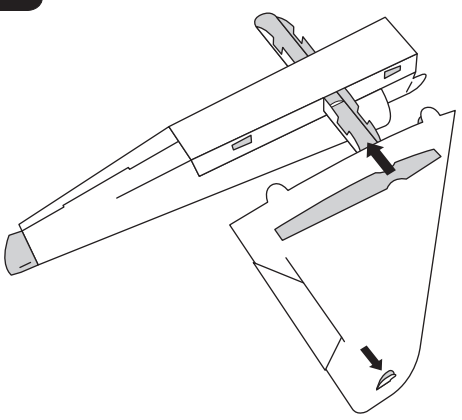

7

UNDERCARRIAGE FAIRINGS (x2)

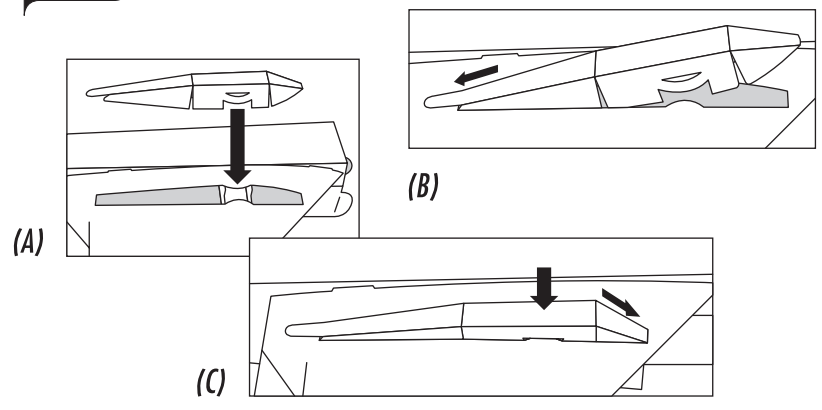

8

TAIL FIN ROOT

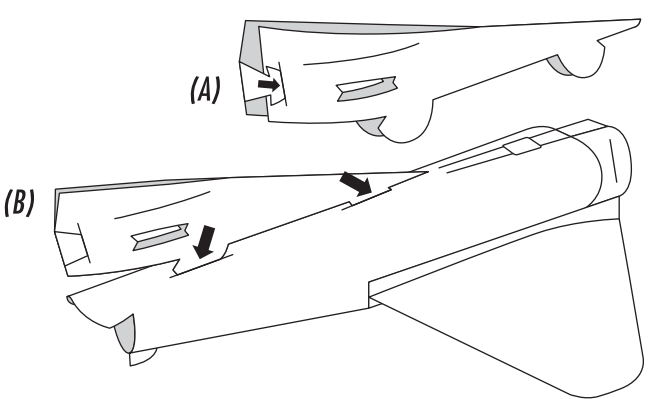

9

TAIL FIN / RUDDER

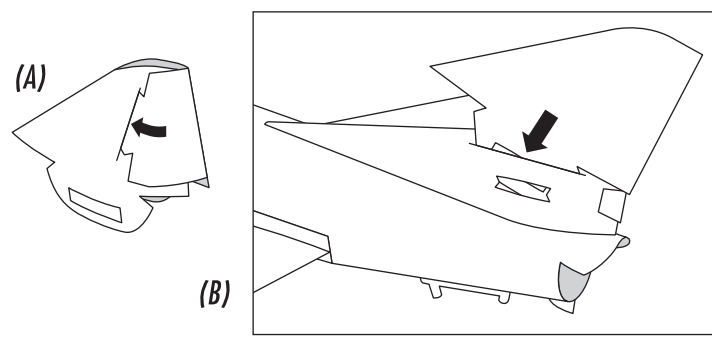

10

## TAILPLANES (x2)

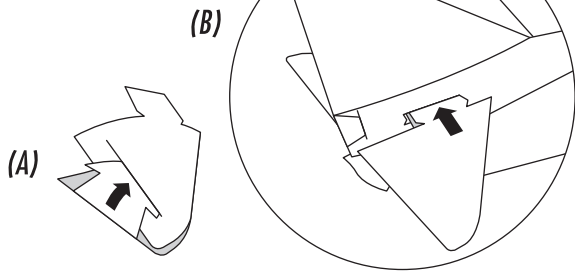

11

## EXHAUST NOZZLE

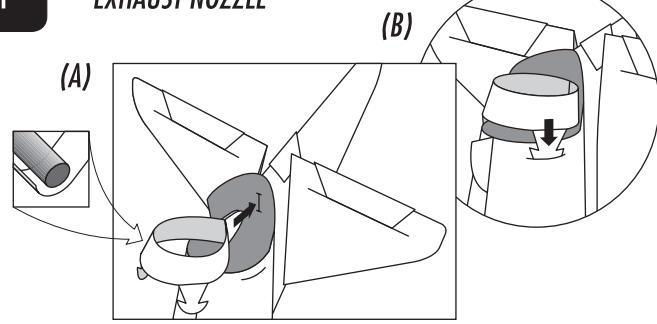

12

## NOSE / COCKPIT

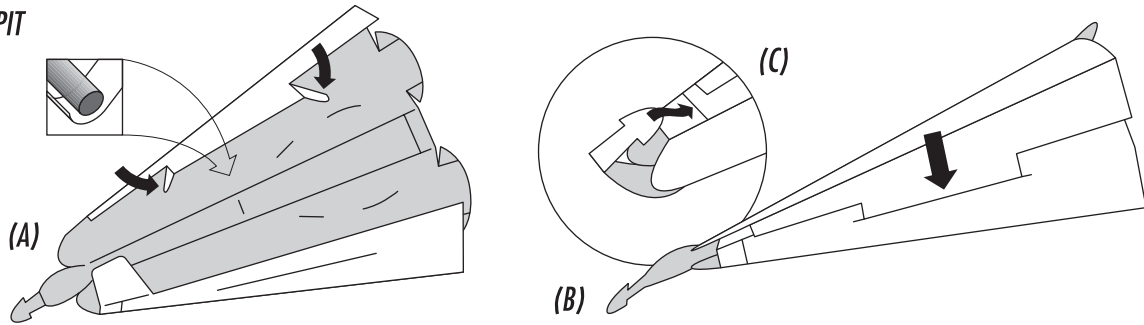

13

## CANOPY / FUEL PROBE / GUN BLAST DEFLECTORS

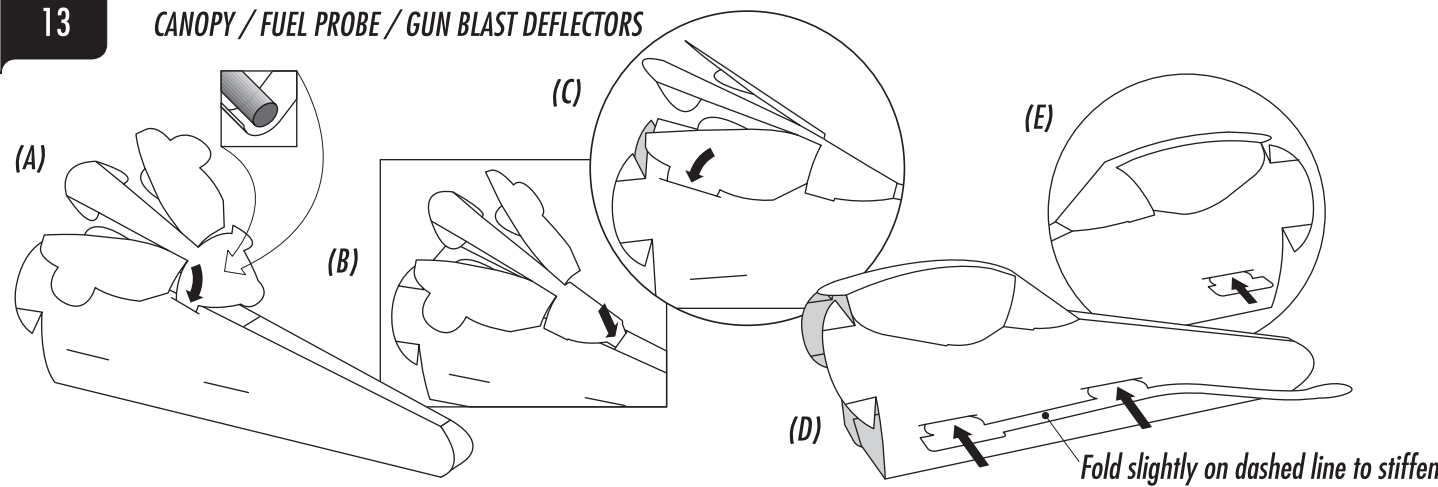

14

## NOSE / FUSELAGE

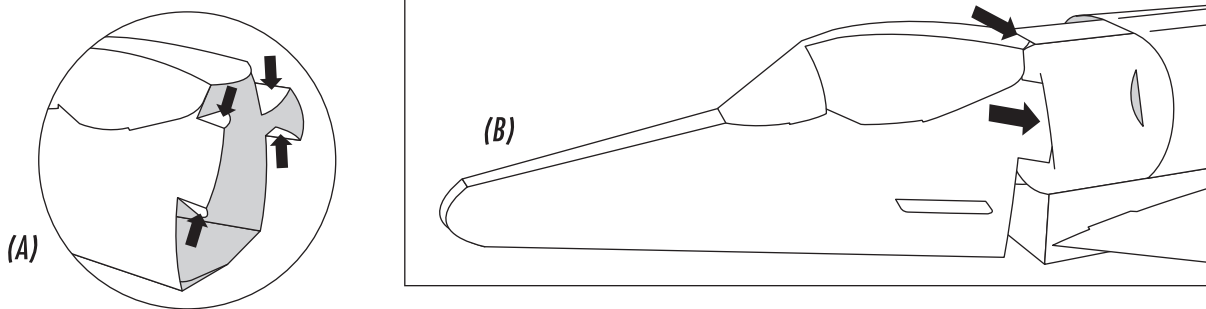

15

## INTAKES (x2)

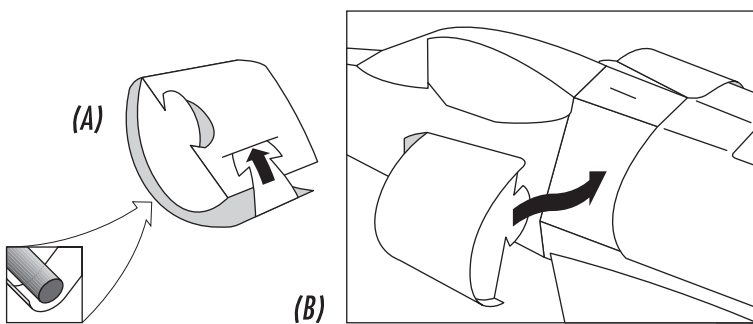

16

## AERIAL FIN

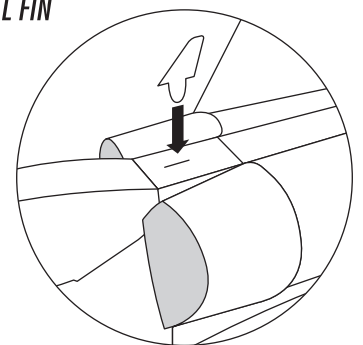

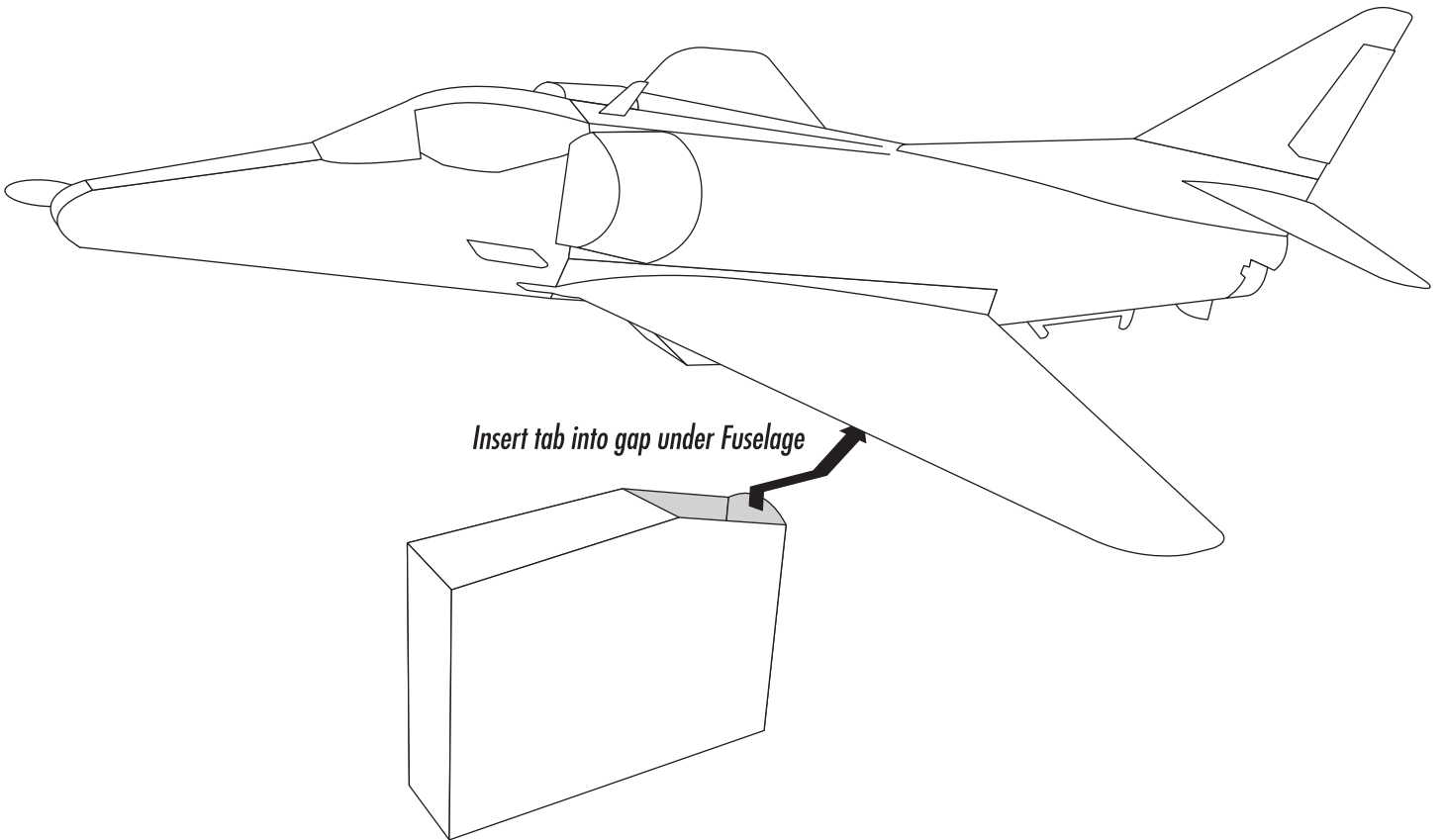
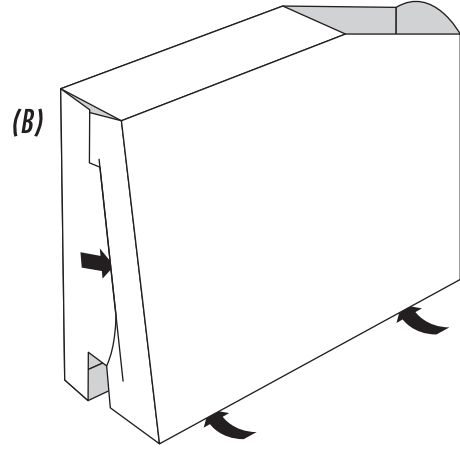
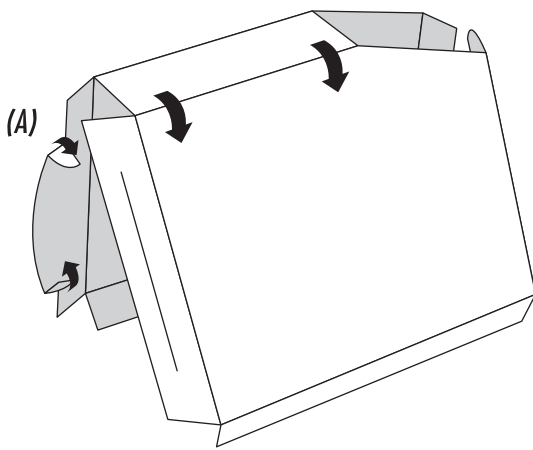

**PORT UNDERCARRIAGE FAIRING**

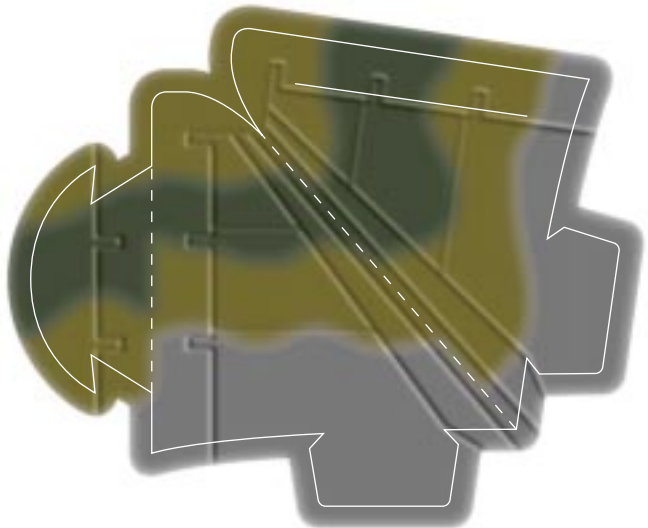
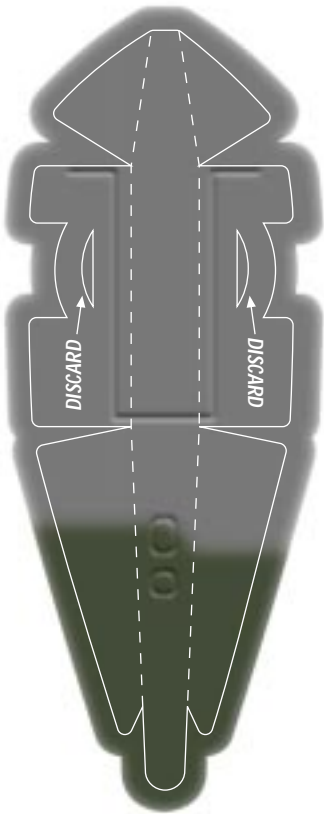

**PORT TAILPLANE**

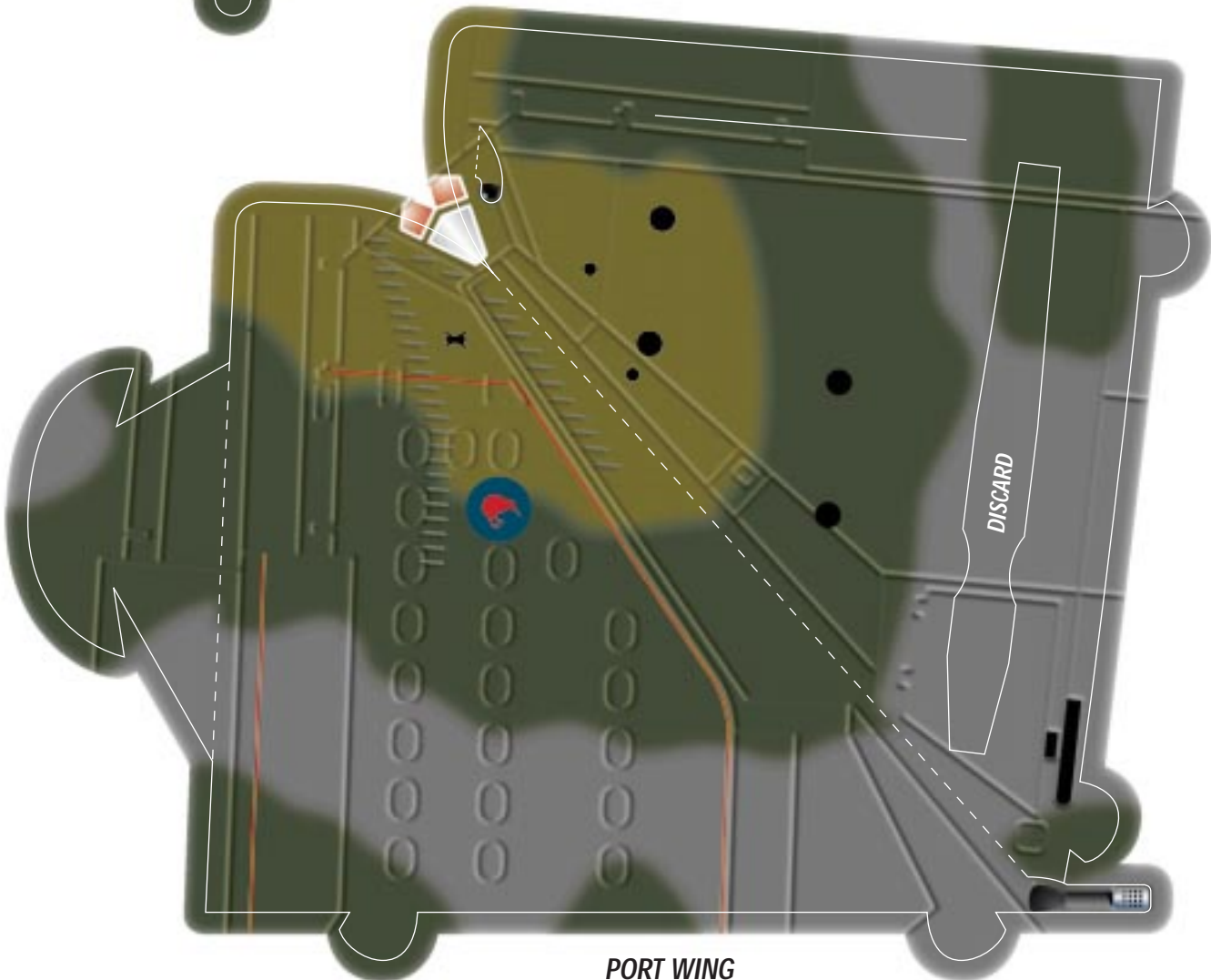

**PORT WING**

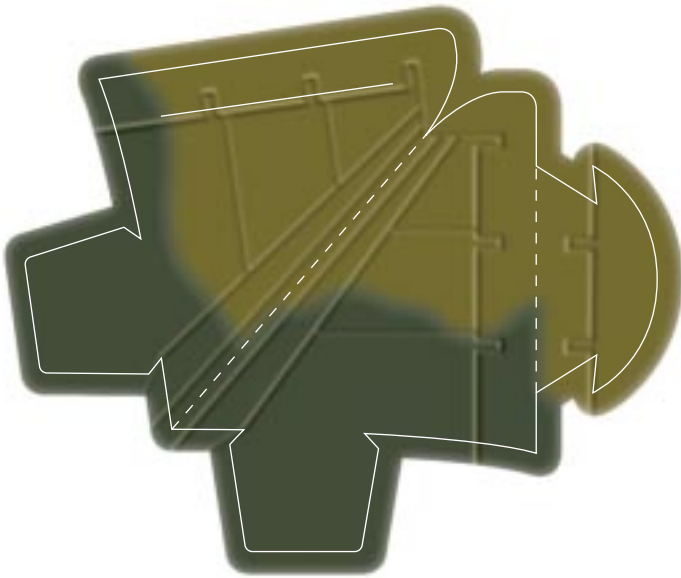

STARBOARD TAILPLANE

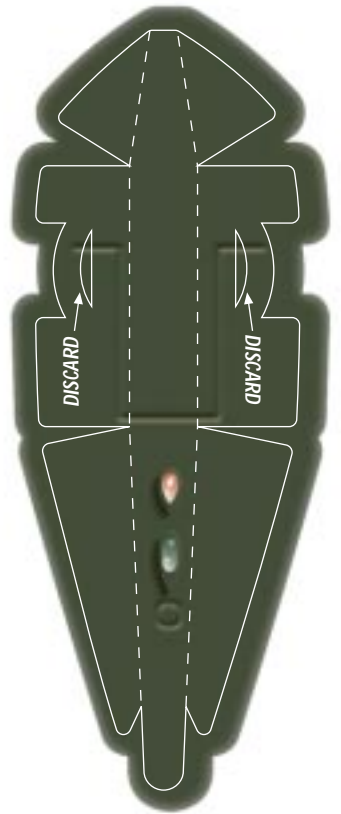

STARBOARD WING

FUSELAGE

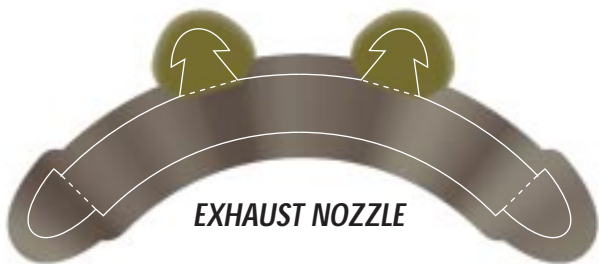
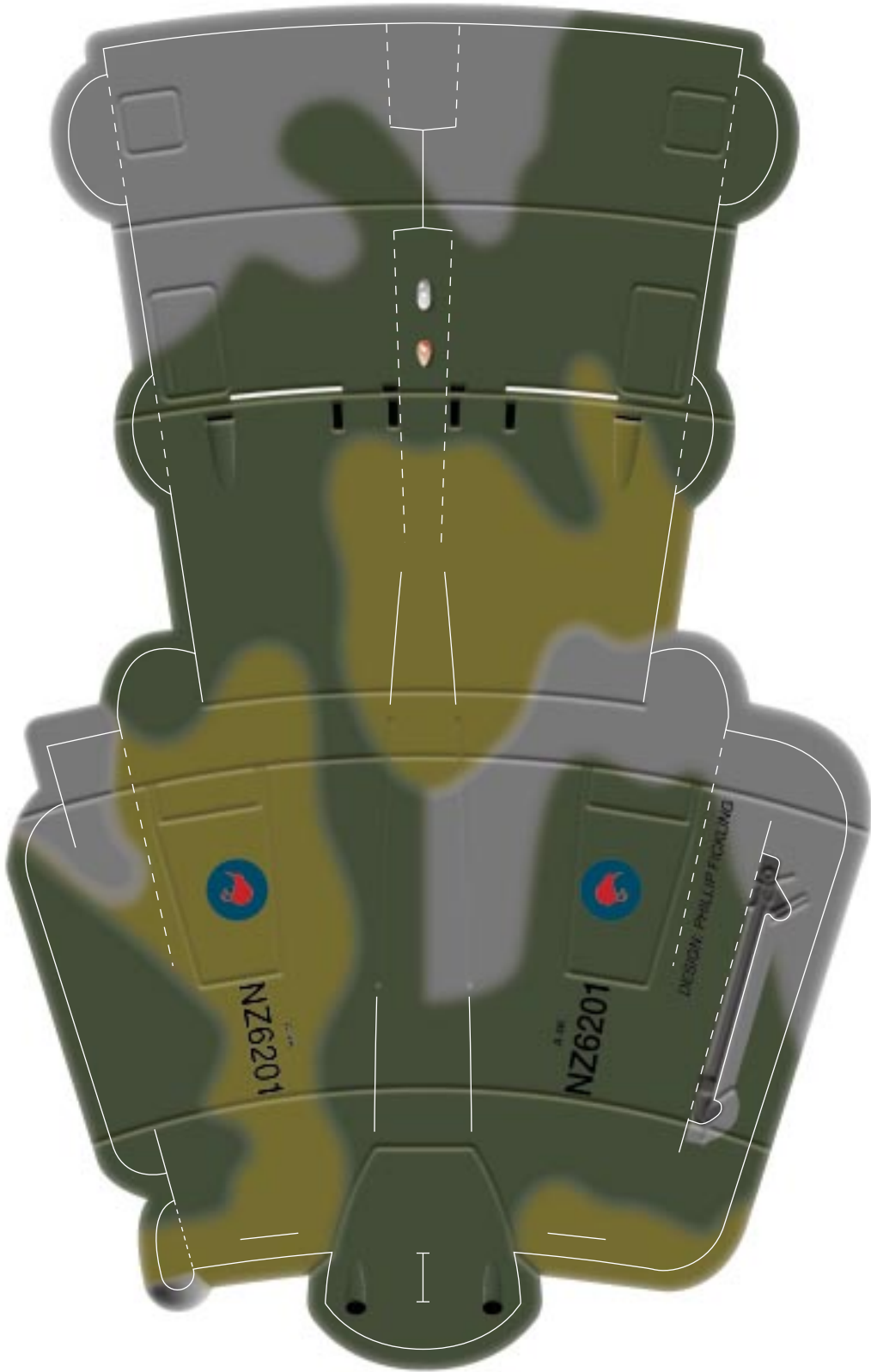

EXHAUST NOZZLE

**TAIL FIN ROOT**

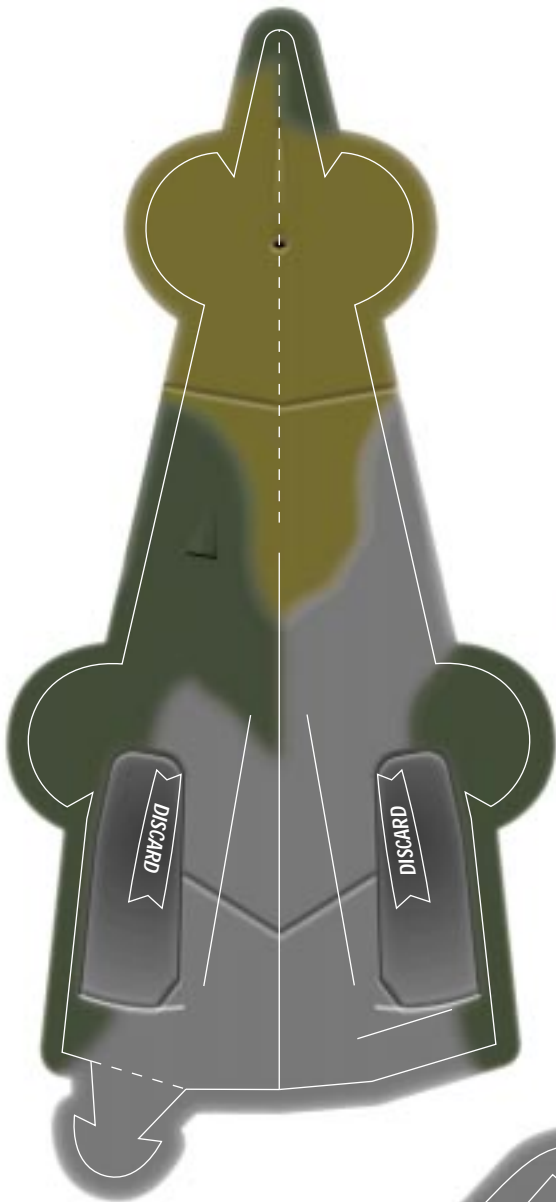

**STARBOARD INTAKE**

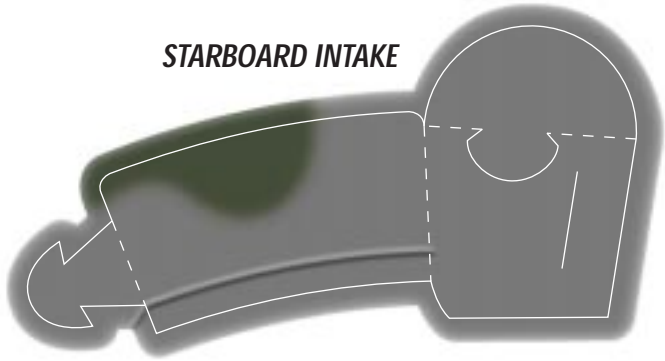

**PORT INTAKE**

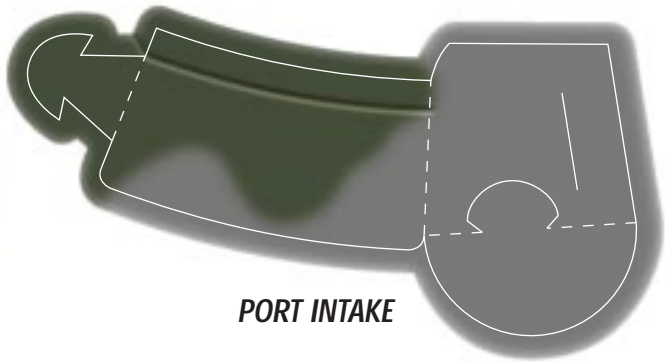

**TAIL FIN / RUDDER**



**WING SPAR**

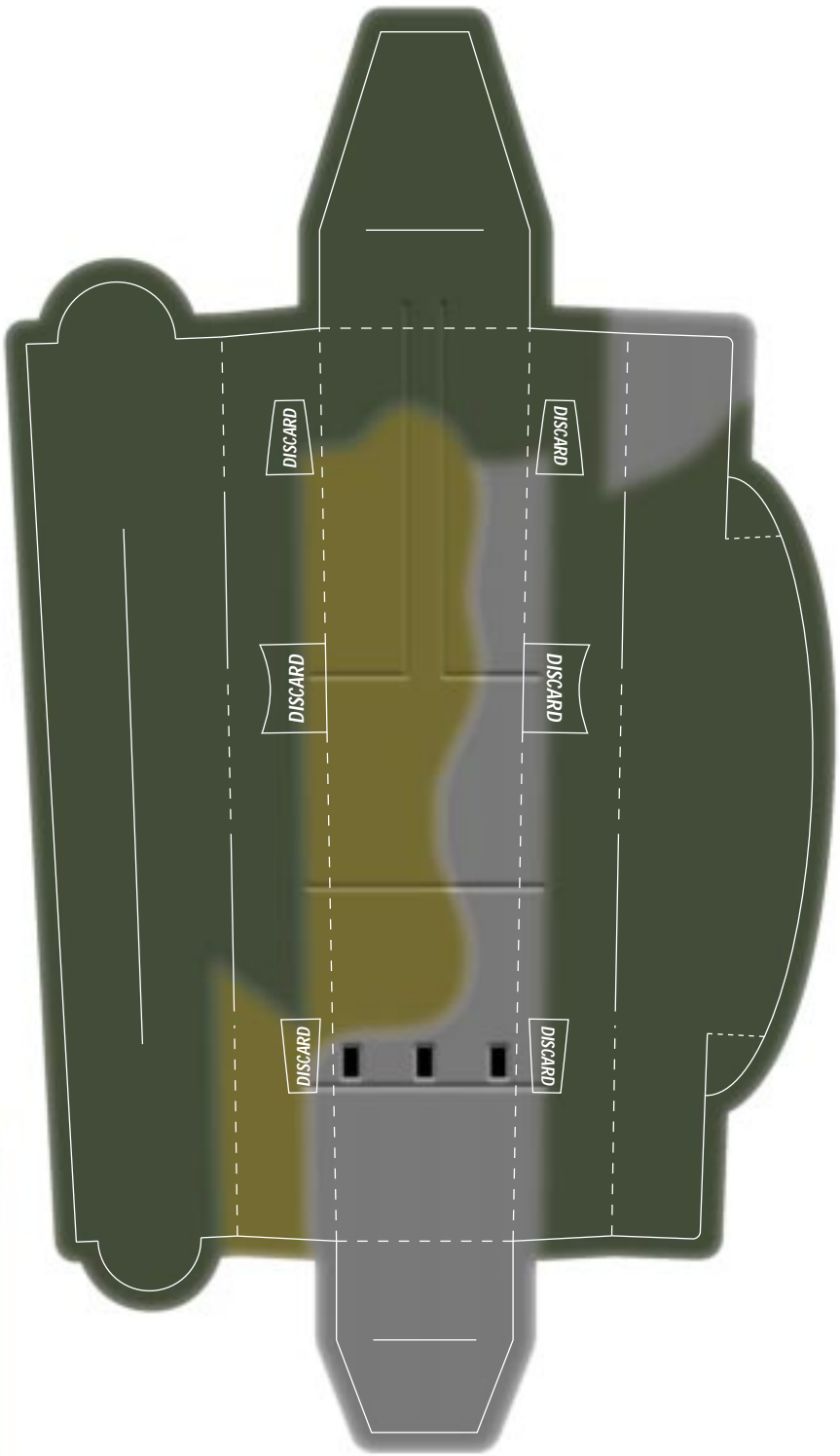
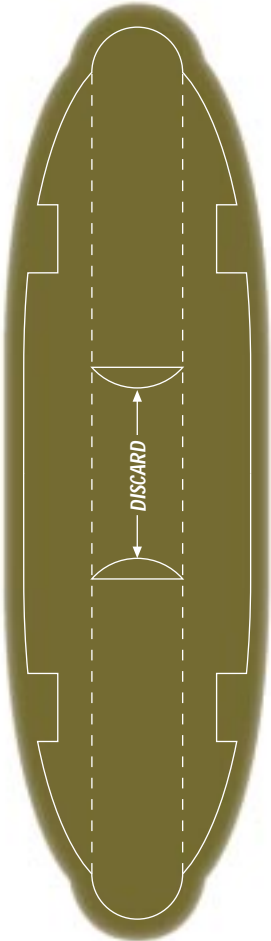

**FUSELAGE MAINFRAME (BOTTOM)**

**FUSELAGE MAINFRAME (TOP)**

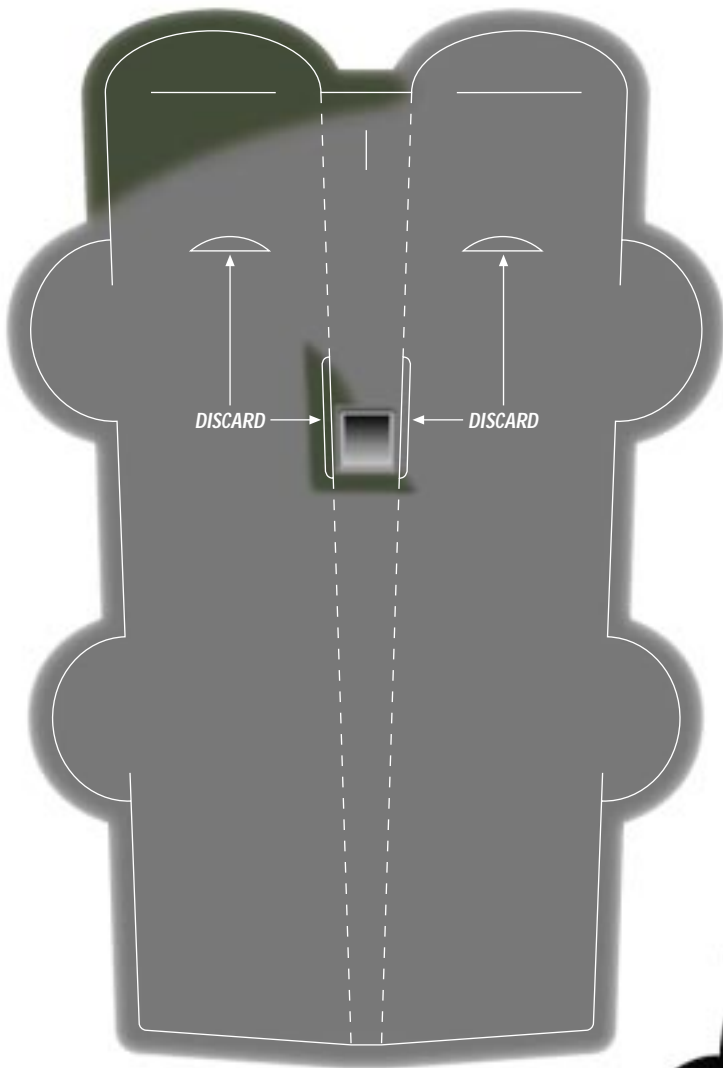

**FUEL PROBE /  
STARBOARD GUN BLAST DEFLECTOR**

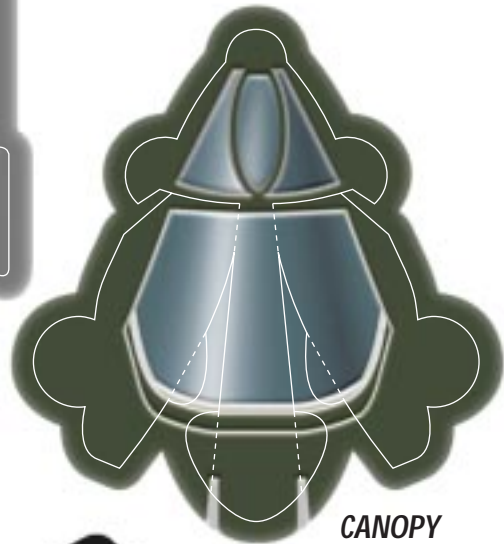

**CANOPY**

**AERIAL FIN**



**PORT GUN BLAST  
DEFLECTOR**

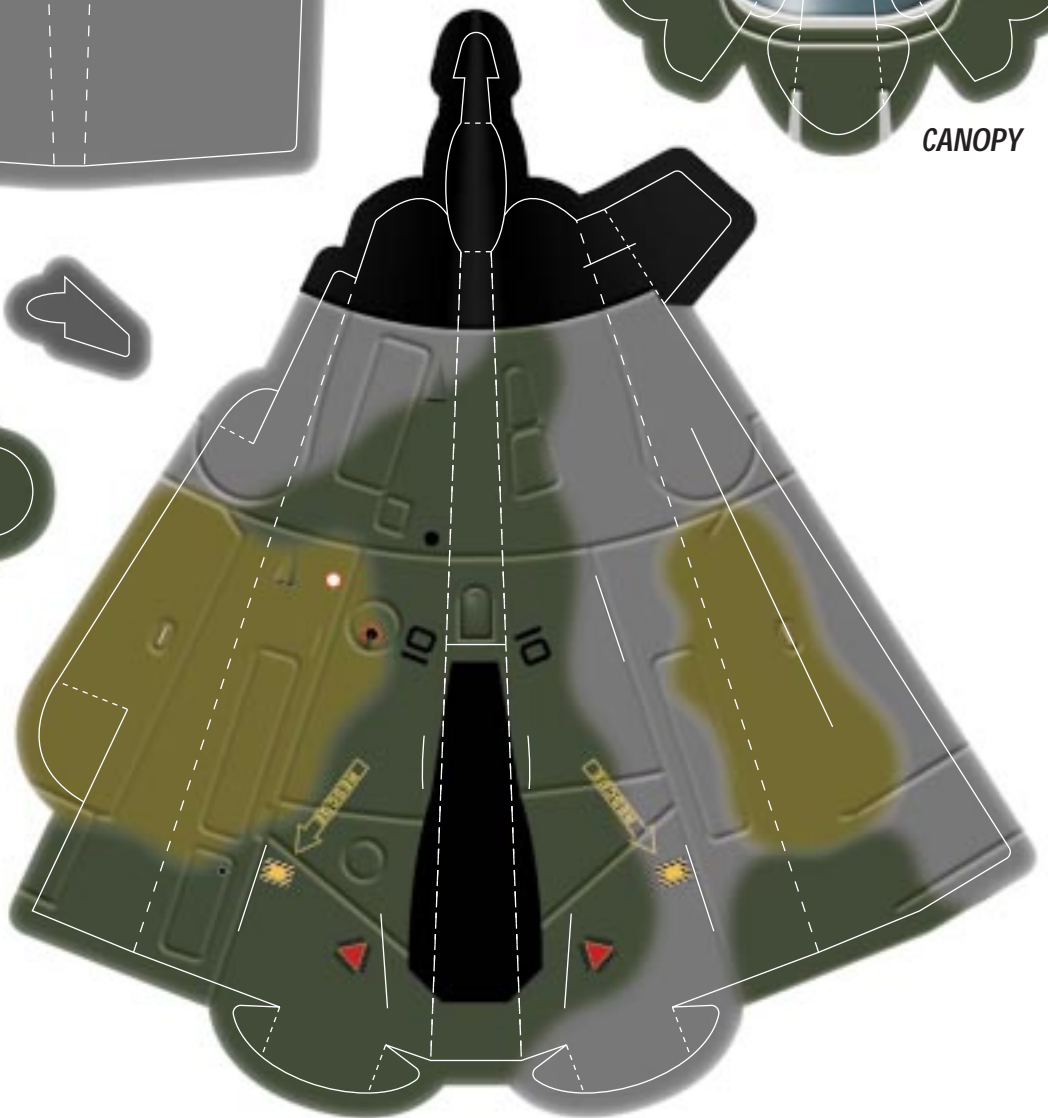

**NOSE / COCKPIT**

FEEL THE FORCE

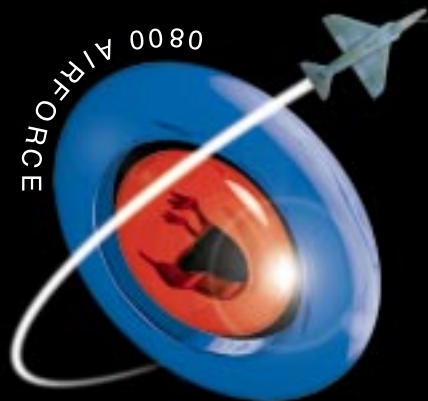

A4K  
SKYHAWK

SPECIFICATIONS

**TYPE:** *Single-seat Attack Aircraft*

**POWERPLANT:** *One 4173kg Pratt & Whitney J52 P8B turbojet*

**PERFORMANCE:** *Maximum speed with one 454 kg bomb, 1066 km/h*

**WEIGHTS:** *Empty, 5363 kg, Maximum, 11136 kg*

**DIMENSIONS:** *Span, 8.38 m, length, 12.29 m, height, 4.57 m*

**ARMAMENT:** *Underfuselage hardpoint with a capacity of 1181 kg, two inboard underwing hardpoints with a capacity of 909 kgs each, two outboard underwing hardpoints with a capacity of 227 kgs each. An extensive range of precision laser guided bombs, Maverick air-to-ground missiles and rockets can be carried for the attack role, as well as infrared guided missiles and two 20 mm cannons for the air-to-air environment.*